

9311

The technical drawing consists of two views of a boat hull:

- Side View (Top):** Shows the profile of the hull. The total height from the baseline to the highest point of the cabin is 277. A reference mark "0" is located at the bottom right.
- Top View (Bottom):** Shows the plan view of the hull. Key dimensions include:
 - Overall width: 622
 - Width at the bow/stern: 150
 - Width at the cabin entrance: 150
 - Length of the cabin: 578
 - Length of the transom: 200

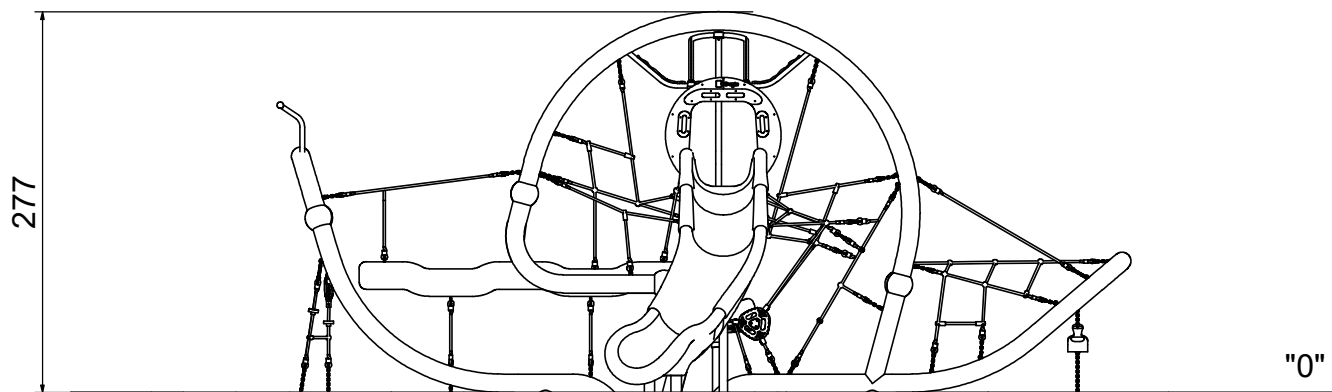

9311N

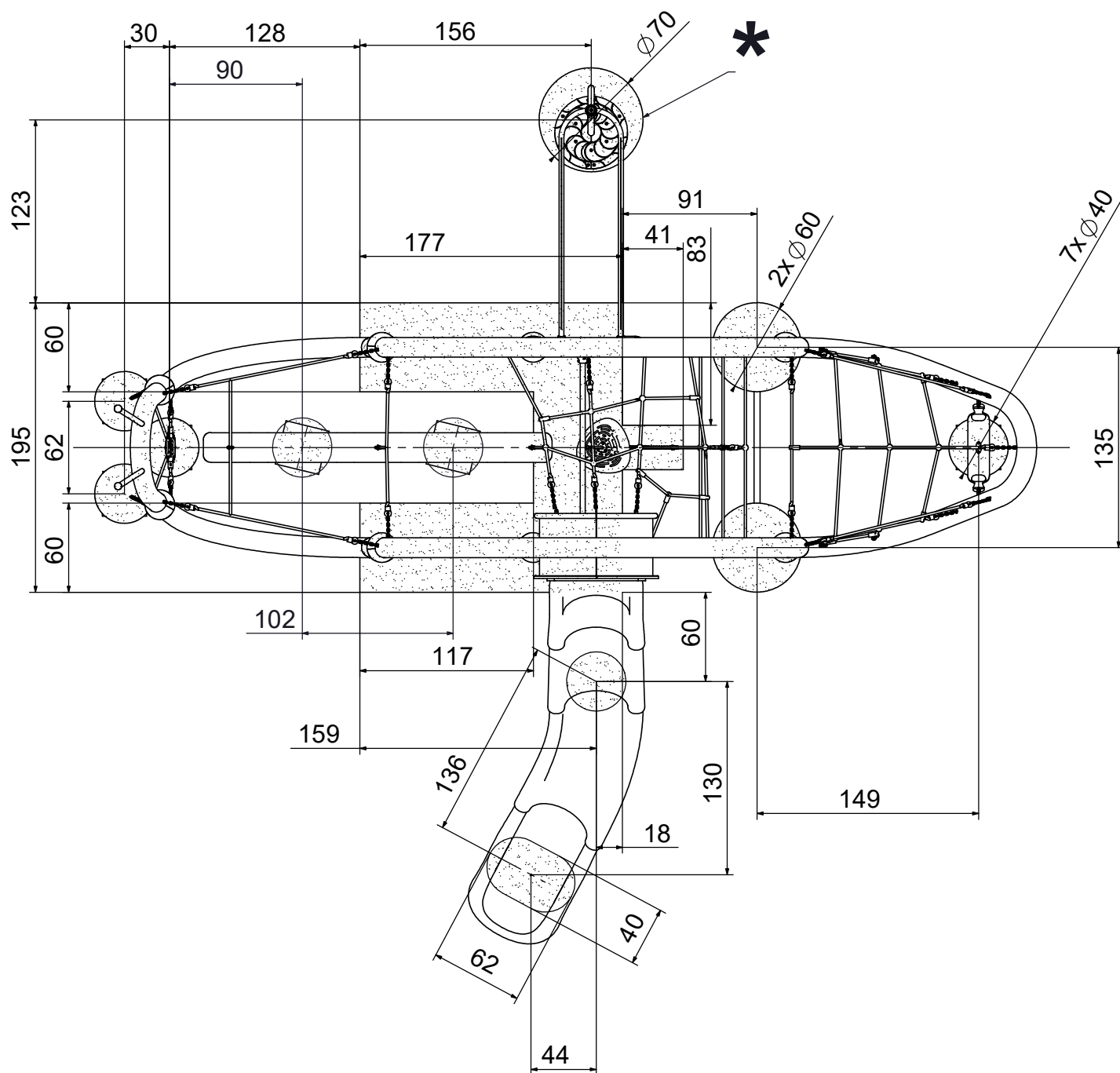
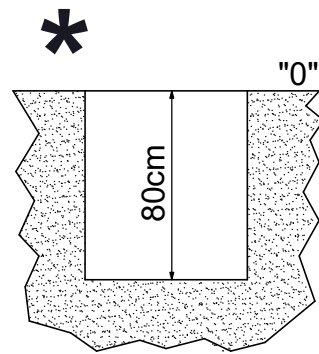
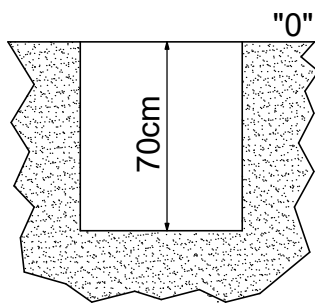

1

9311

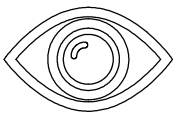

INST_93_0
INST_93_29

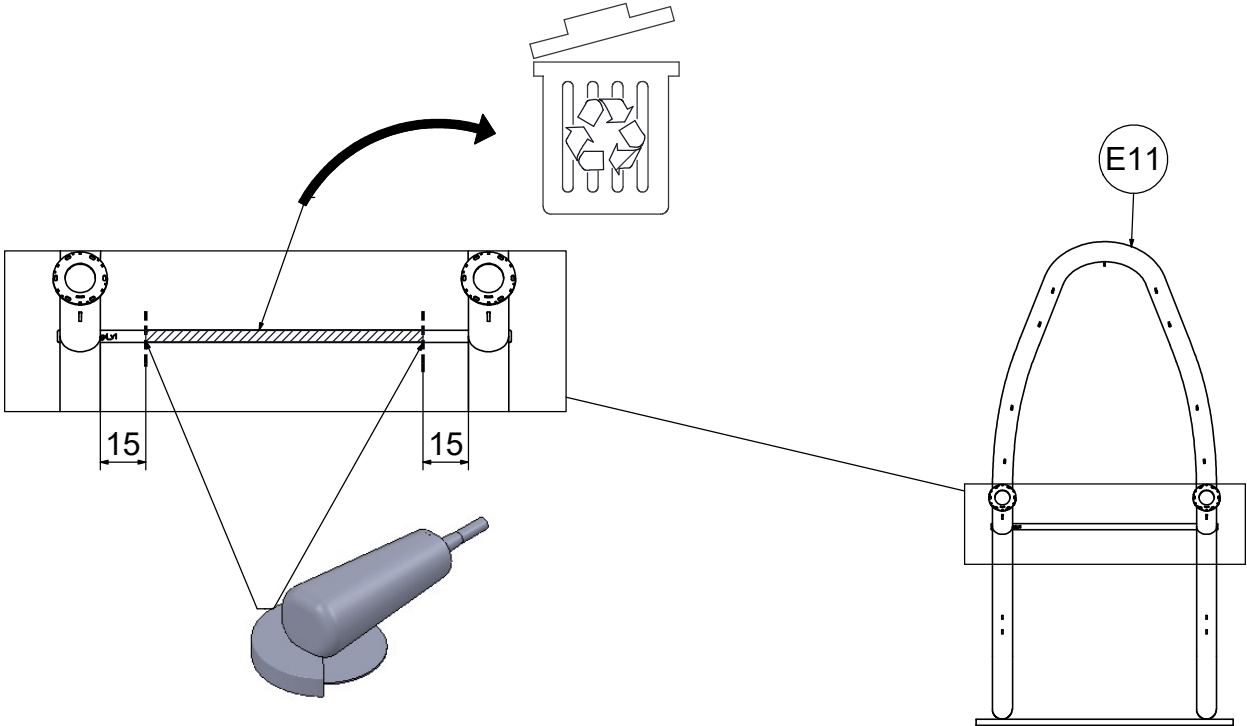
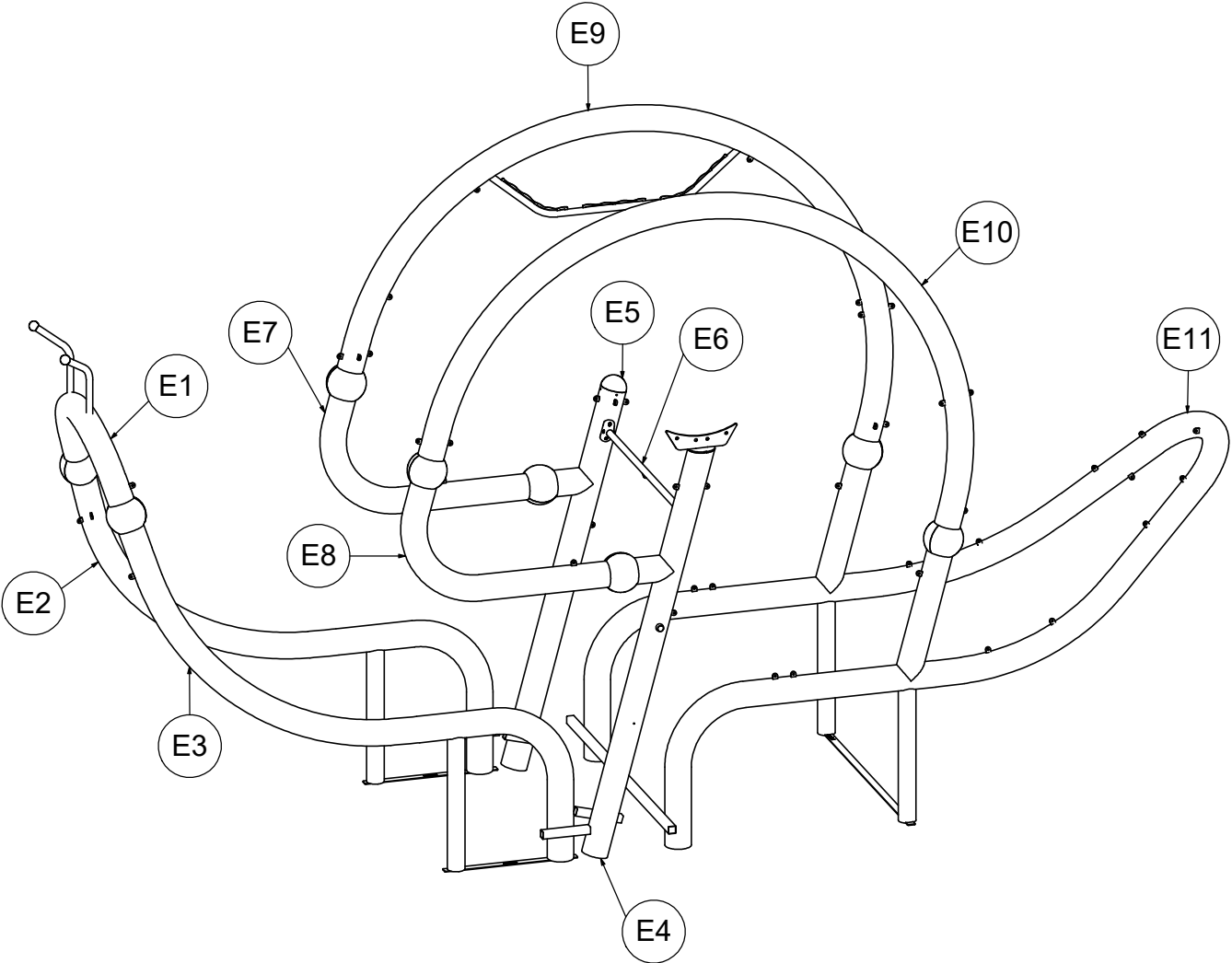

2

9311

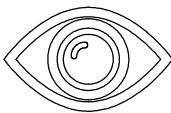

INST_93_0_1
INST_93_0_2
INST_93_0_3
INST_93_108

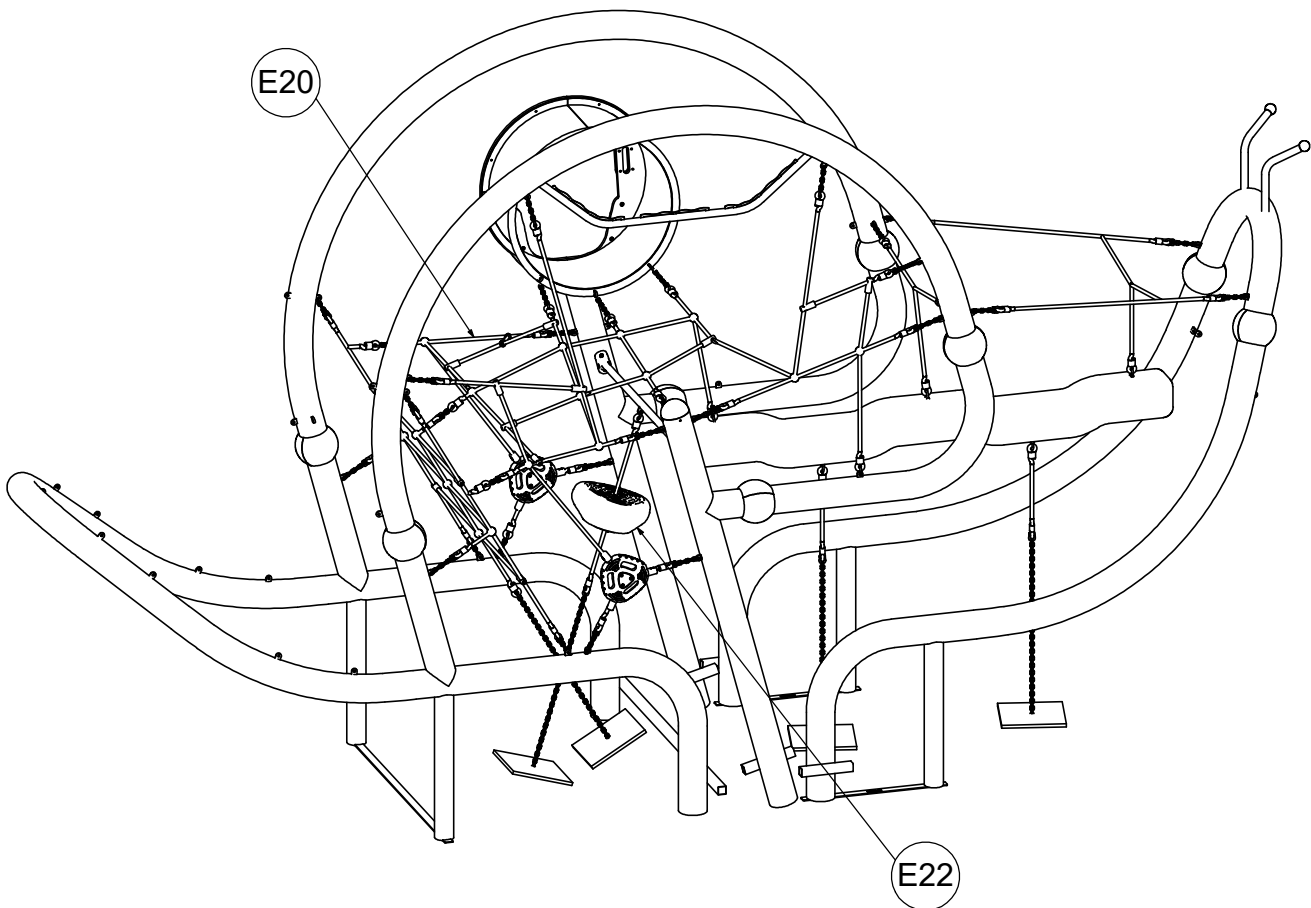
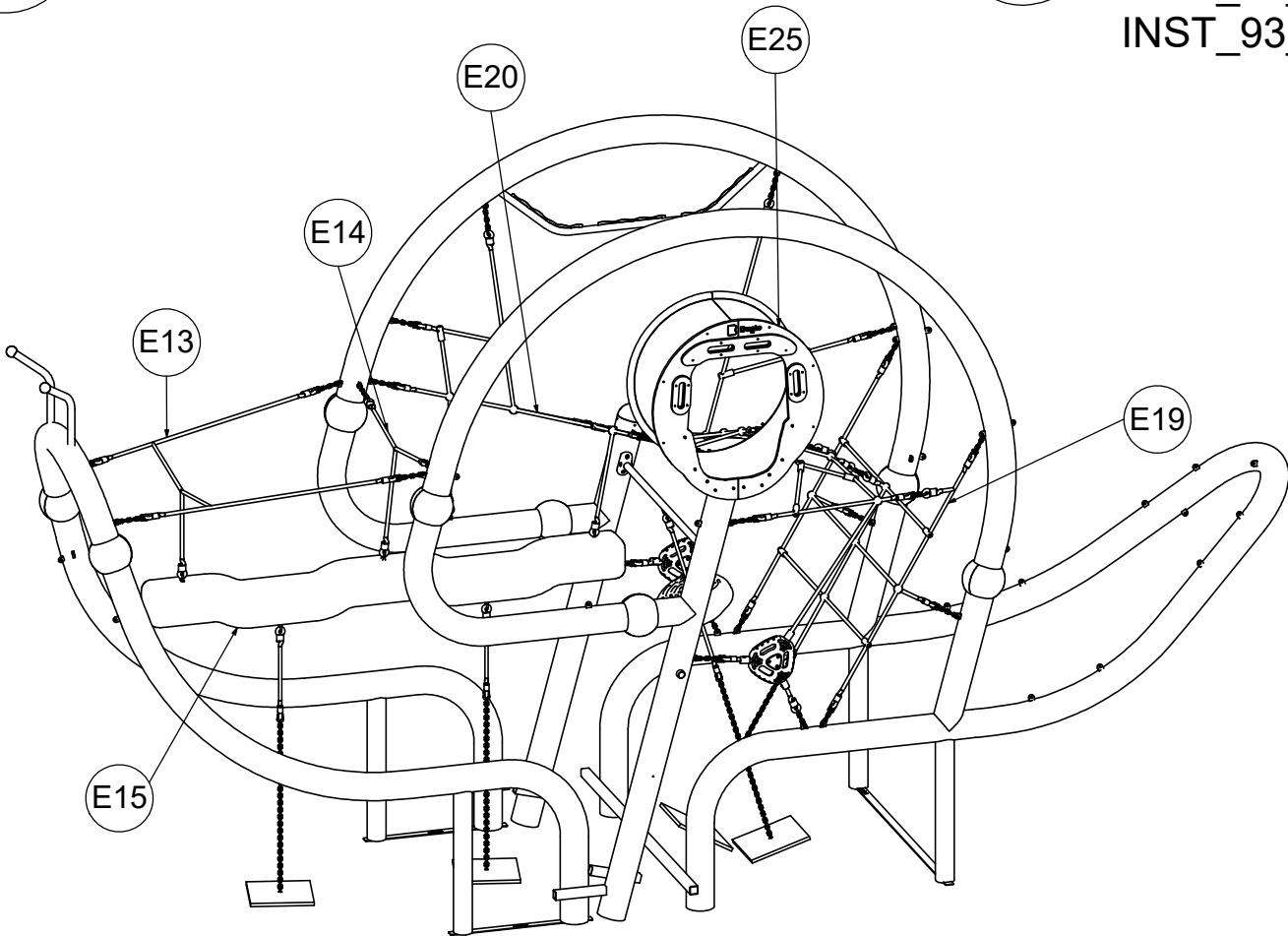

3

9311

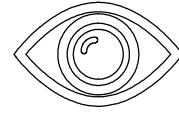

INST_93_0_1
INST_93_0_2
INST_93_0_3

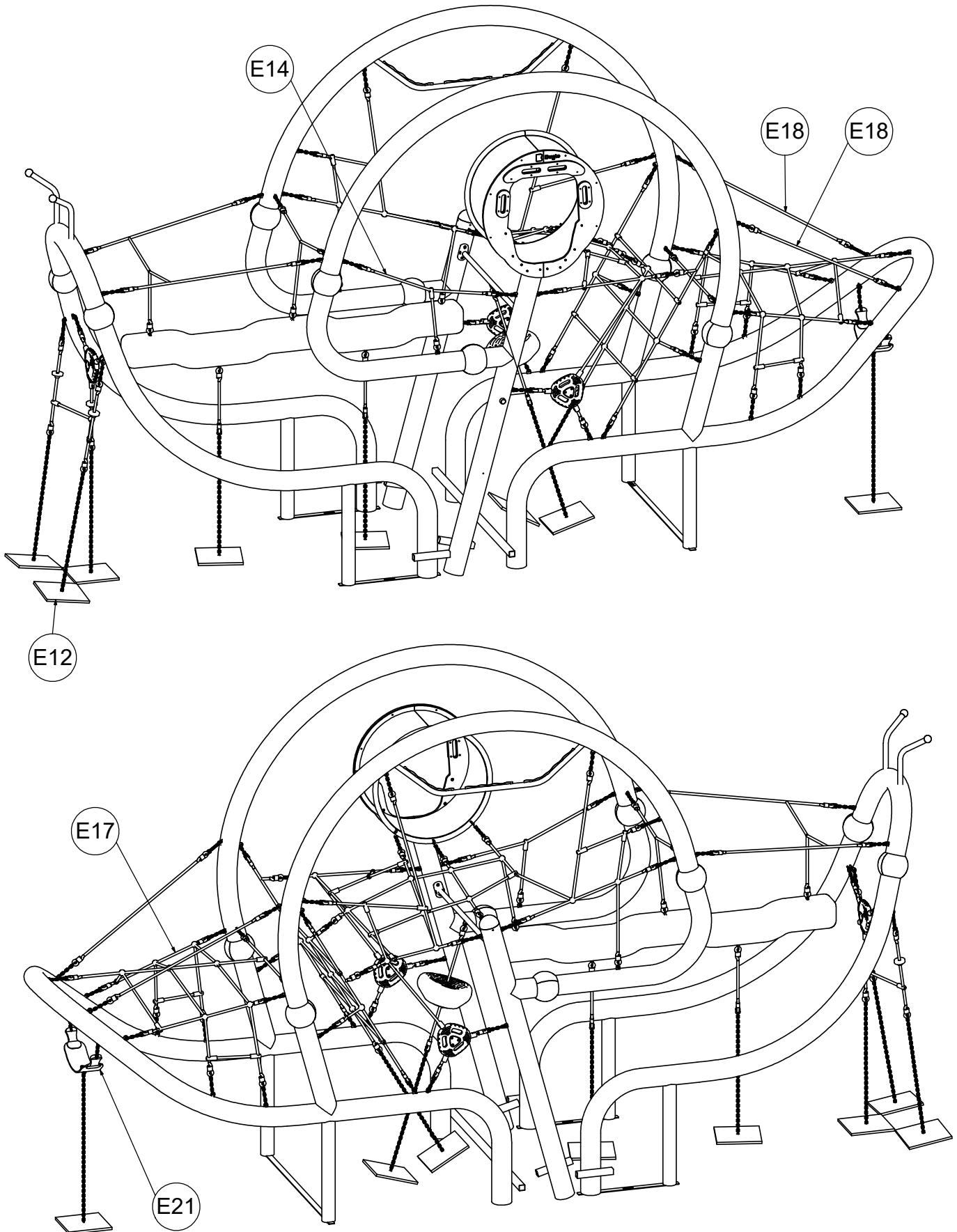

4

9311

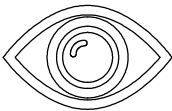

INST_93_107
SMOL_150_1245
INST_Z_1

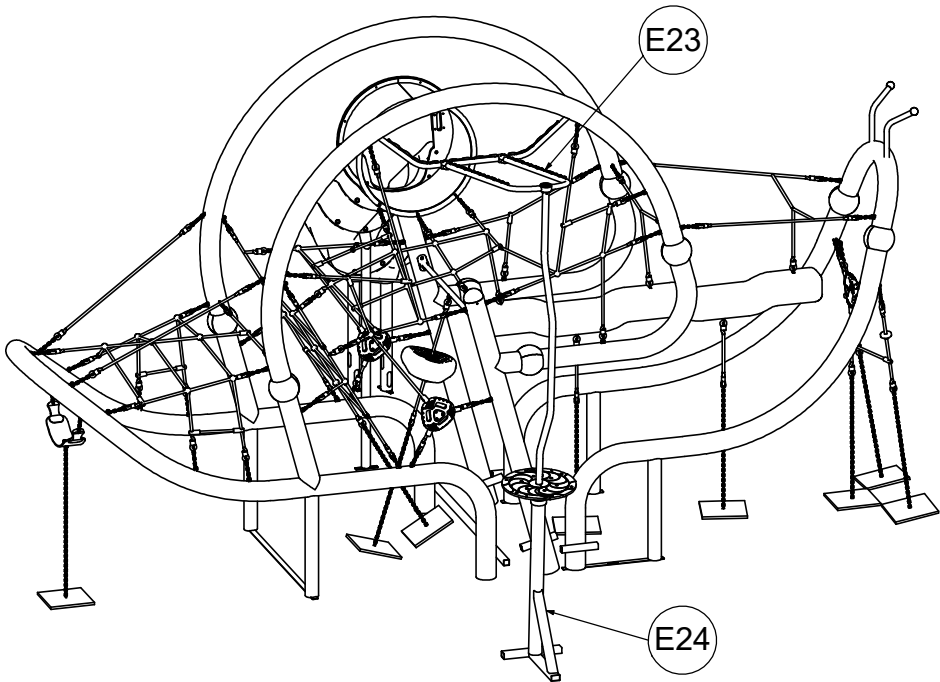
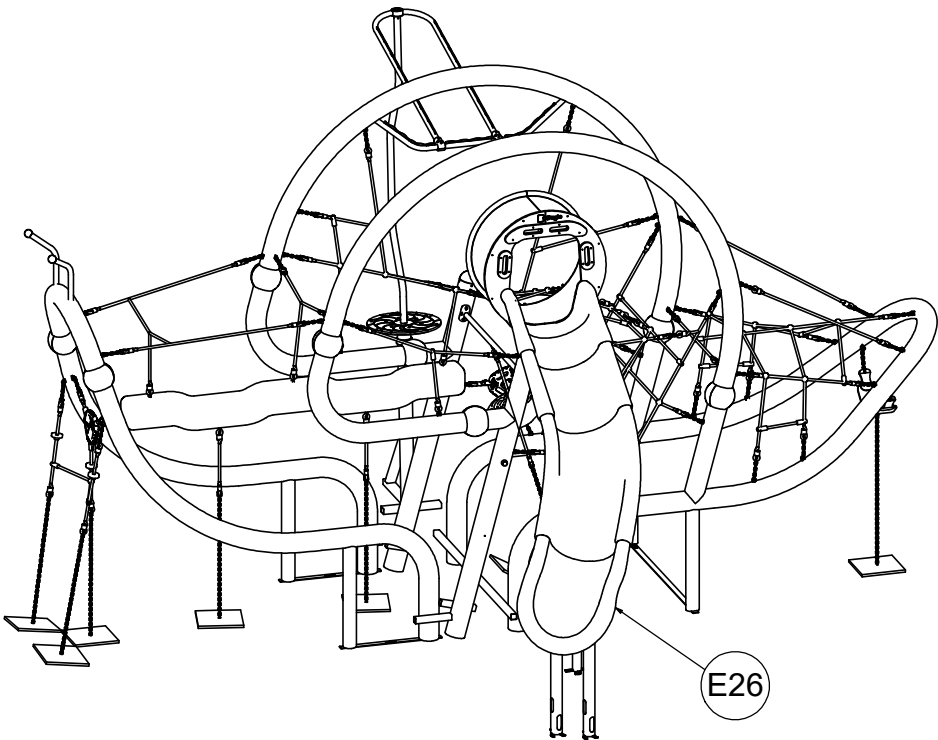

9311N

B25 1,4m³

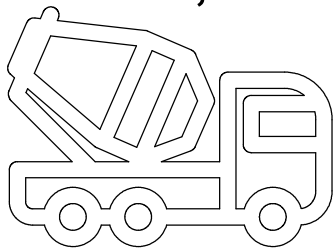

min. 48H

